



Residential Building Permit Application

216 E MAIN AVE RITZVILLE WA 99169
509-659-1930 City Hall 509-659-0253 Fax
Julie.Flyckt@ritzville-wa.us

PROPERTY OWNER INFORMATION			
OWNER NAME:			
Project Owner's Mailing Address / City / State [Zip			Phone Number
Fax Number	Cell Number	Email	
Authorized Agent (if different from Property Owner)			Phone Number
Primary Contact:	Phone Number	Email	
PROPERTY INFORMATION AND LOCATION			
JOBSITE ADDRESS			
Tax Parcel #	Subdivision	Lot #	Block
Description of Project		Valuation \$	
Lender Information — required for projects over \$5000 in valuation per RCW 19.27.095 If a lender or bond company <u>is not</u> loaning monies on this project, please check here: <input type="checkbox"/>			
LENDING INSTITUTION:			Phone number:
Address / City / State / Zip			
GENERAL CONTRACTOR INFORMATION			
COMPANY NAME:		UBI #	
Address / City / State / Zip			Phone Number
Fax Number	Cell Number	Email	
ARCHITECT (if applicable)	Phone Number	Fax Number	
Address / City / State / Zip			Email
ENGINEER (if applicable)	Phone Number	Fax Number	
Address / City / State / Zip			Email
DETAILED PROJECT INFORMATION			
Main Level Area (sf)	Garage Area (sf)	Number of Fireplaces_____	
Upper Level Area (sf)	Covered Porch / Patio (sf)	LPG Tank <input type="checkbox"/> Natural Gas <input type="checkbox"/> Wood <input type="checkbox"/>	
Basement Area: Heated (valued as finished)	Raised Deck Area (sf) -> 30" in height	Total Square Footage:	

<input style="width: 50px; height: 20px;" type="text"/> _____ (sf) Unheated (valued as unfinished)	Number of Bedrooms:	FOR OFFICE USE ONLY Permit # Initials
<input style="width: 50px; height: 20px;" type="text"/> _____ (sf)	Number of Bathrooms:	
	Building Height:	
TYPE OF SEWER & WATER SERVICE: City Sewer () Private septic () / City Water () Private Well () (All Private Septic and Well Services Require Approval from Adams County Health Dept.)		
<p>I authorize employees and officials of the City of Ritzville and/or Adams County Building and Planning Department the right to enter and remain on the property in question to determine whether a permit should be issued and whether special conditions should be placed on any issued permit. I have the legal authority to grant such access to the property in question.</p> <p>I also acknowledge that if a permit is issued for land development activities, no terms of the permit can be violated without further approval by the permitting entity. I understand that the granting of a permit does not authorize anyone to violate in any way any federal, state, or local law/regulation pertaining to development activities associated with a permit.</p> <p style="text-align: center;">I hereby certify under penalty of perjury under the laws of the State of Washington that the following is true and correct:</p> <ol style="list-style-type: none"> 1. I have read and examined this permit application and have documented all applicable requirements on the site plan. 2. The information provided in this application contains no misstatement of fact. 3. I am the owner(s), the authorized agent(s) of the owner(s) of the above referenced property, or I am currently a licensed contractor or specialty contractor under Chapter 18.27 RCW or I am exempt from the requirements of the Chapter 18.27 RCW. 4. I understand this permit is subject to all other local, state, and federal regulations. <p>Note: This application will not be processed unless the above certification is endorsed by an authorized agent of the owner(s) of the property in question and/or the owner(s) themselves. If the City of Ritzville and/or Adams County has reason to believe that erroneous information has been supplied by an authorized agent of the owner(s) of the property in question and/or by the owner(s) themselves, processing of the application may be suspended.</p>		

Owner Signature: _____ Date _____

Contractor Signature: _____ Date _____

Building Inspector: _____ Date _____

City Clerk: _____ Date _____

SITE PLAN

Permit # _____

1234 Sample Street

North



100'

10' Utility Easement

Driveway

25'

35'

Existing Single Family Residence

1234 Sample Street

30'

8'

Septic Tank

5'

Proposed 10' x 16'
Covered Patio

6'

12'

35'

Reserve
Area

10' x 35'

35'

Existing

16' x 16'

Shed

10'

5'

75'

20'

10' Irrigation Easement

150'

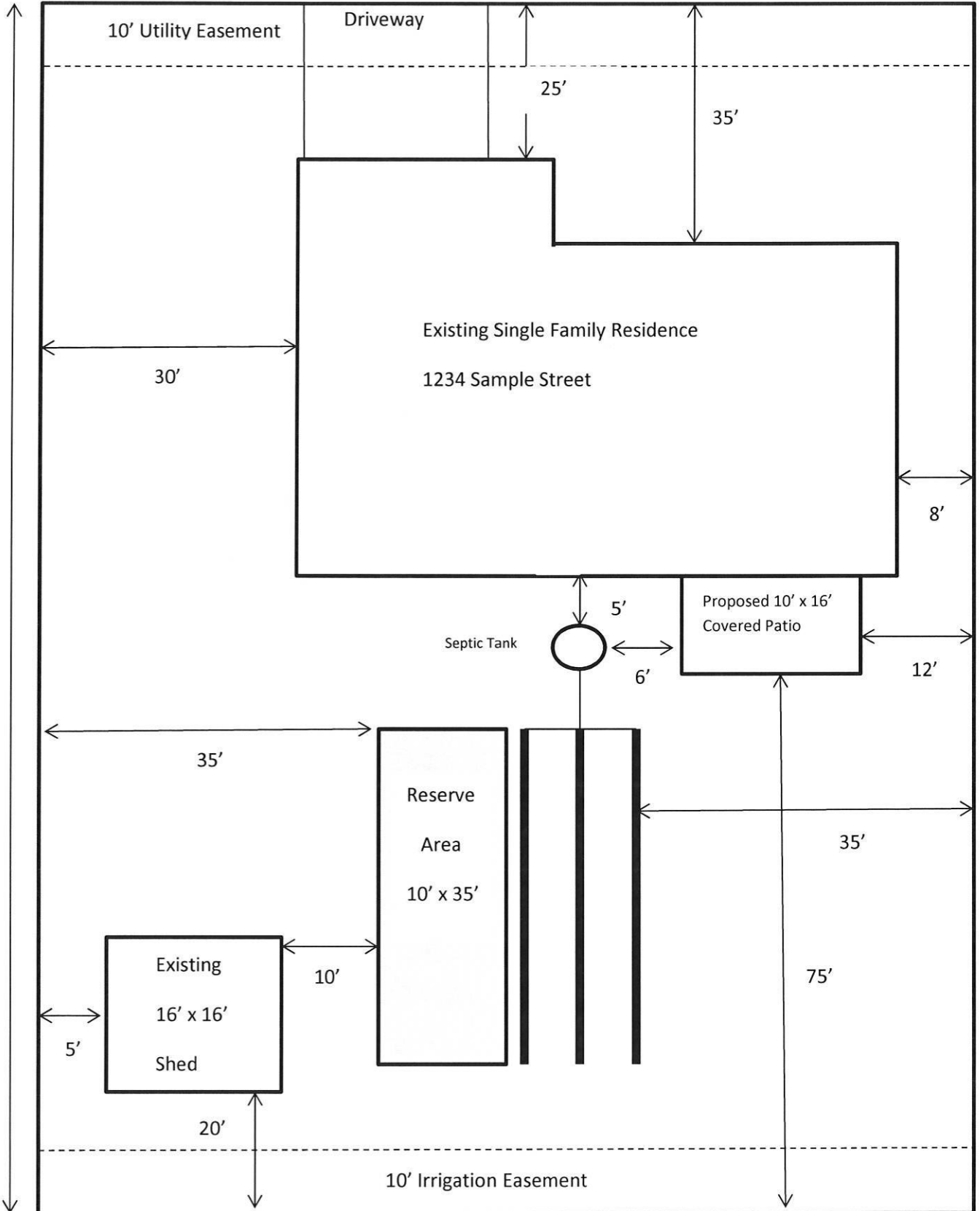



Residential Building Permit Application

216 E MAIN AVE RITZVILLE WA 99169

509-659-1930 City Hall 509-659-0253 Fax

Julie.Flyckt@ritzville-wa.us

BUILDING PERMIT ACTIVITY - AUTHORIZATION FORM

As legal owner(s) of Parcel

I acknowledge and approve the request for permit(s) and construction for:

Further, I hereby authorize the following person(s) to act as my agent(s) regarding any activities involving the Application, and subsequent Permit, as noted above and filed with the city of Ritzville:

Name Company

Name Company

Legal Owner Signature / Corporate Representative Signature

Legal Owner Signature / Corporate Representative Signature

Date

Date

Printed Name

Printed Name

Title / Company (if applicable)

Title / Company (if applicable)

As landowner and applicant for a Building Permit, if you want someone other than yourself to act as your agent, including contractors, engineers, architects, etc., you must complete this form and submit with each applicable application.

In cases of co-ownership, all legal owners must sign the form or attach additional forms.

Corporations and Trusts must have signature by at least one governing member or agent authorized to bind the corporation or trust.